

# FRESKO

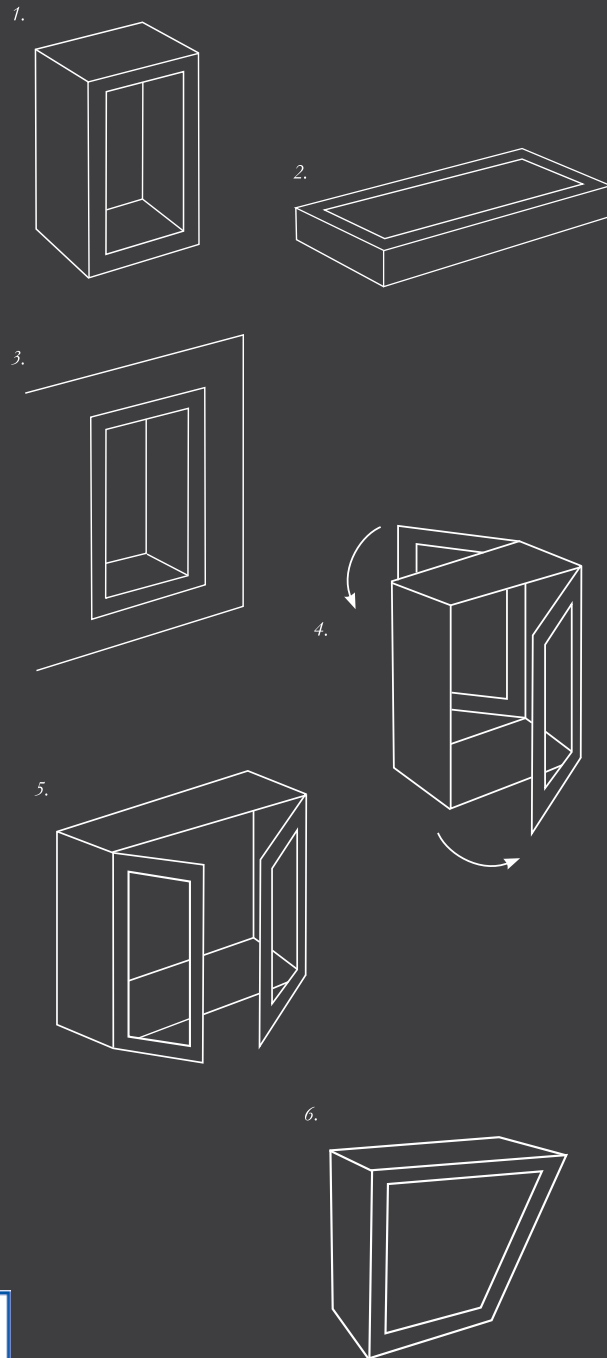

*Fresco case (above and below) - Photography by Netherfield*



- 1. Wall Mounted
- 2. Table Top
- 3. Flush Mounted
- 4. Back to Back
- 5. 2-Door Fresco
- 6. Custom Shape



designcase



*Fresco (Prism case on bench) - Old Parliament House, Canberra*

These secure hinged case fronts are widely specified for fitting to a steel, plywood or EO MDF carcass. They provide a high security case with 100% hinged door access. The dual action hinge is fully concealed and located at the top and bottom of each frame. The door opens within its own width allowing these cases to be inset or flush mounted into a wall or recess. A case set through a wall can have a Fresco front on either side.

Fresco is supplied either as a case front only or with a carcass. The carcass can be fitted with a wide range of lighting and shelving options. Carcass dress panels can be exchanged for glass to achieve various lighting options internally, including a choice of fibre optic and LED lighting. The Fresco front can be fitted to any depth of carcass. Shallow cases can be created using only the Fresco front with an integral back. These are ideal for the display of thin items such as coins, medals, documents, insects etc. and can be either wall, angled or flat mounted.

# designcase

Phone 02 6290 4900

[www.designcase.net.au](http://www.designcase.net.au)

Multiple Fresco case fronts are a very cost effective means of creating very large cases with an uninterrupted internal space. The Fresco system offers many versatile and creative design solutions. The Fresco case frames have invisible mitred and welded corner joints and are supplied with a powder coated finish to any Dulux or Interpon powder coat colour specification with other finishes available on application.

High security, fully concealed Abloy locks are fitted as standard. Museum quality laminated security or anti-bandit specification glass is standard and this provides important protection from external UV radiation. The option of low iron glass ensures that delicately coloured items such as illuminated manuscripts, textiles and art are seen in their true colours.

slimline showcase with secure hinged case front