

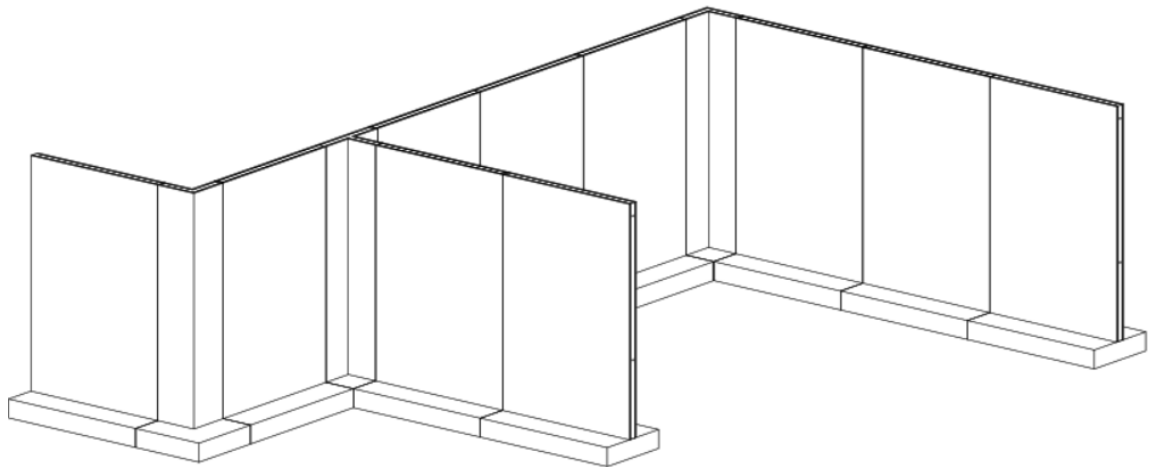

T1 Mobile Display, Gallery and Museum Wall System

Product Information and Overview



Document Revision Date / Number: June 2022-1

Dear Friend of Designcase,

I welcome the opportunity to introduce the Designcase T1, Mobile Display, Gallery and Museum Wall System. T1 is a new product, designed and developed by Designcase, to complement our existing range of Gallery and Museum Products, including its much larger brother - Designcase T2 Wall System. After a prototype development phase, we are now running bulk extrusion and supplying the T1 product to market.

The T1 Mobile Wall System has been developed in our Canberra workshop, and is the culmination of our combined experience with existing proprietary wall systems, and as a response to numerous requests to develop a mobile, easy to deploy, structurally robust, modular Wall System that can be project specific manufactured in Australia.

If you have any queries regarding the Designcase T1 and T2 Gallery Walls, or any of our Proprietary Showcases, or our Museum lighting options from LjusDesign, please do not hesitate to contact me.

Why not have a look at what we do: [Home | designcase](#)

I sincerely look forwards to working with you on a project in the near future.

Yours sincerely,

Phillip Quartly
Manager Museum Projects
P: 02 6290 4901
M: 0423 023 735

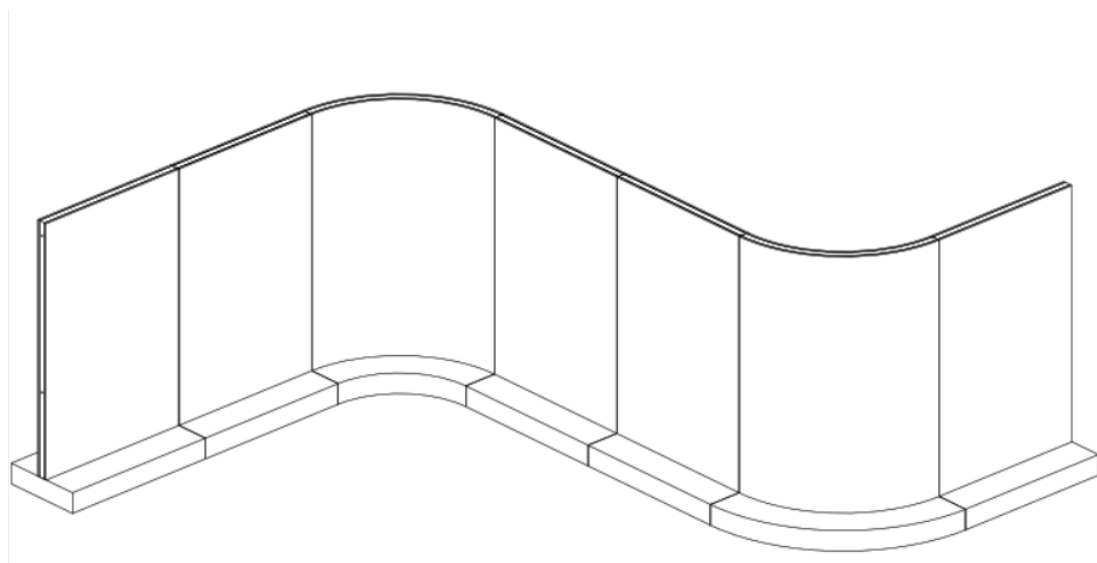

Standard, Straight T1 wall modules with 90 degree Curved linking modules.

T1 has the following build specifications and product features:

- Heavy duty internal aluminium frame structure, with (joinery as standard) Face Panels. The vertical blade can be removed from the base frame for flat-pack storage and freight. Base structure supplied with x4 80kg non-marking 360degree rotation castors as standard. Structural aluminium frames can be supplied with powdercoat finish throughout to client nominated colour.
- Standard (or straight) Modules are based on a 1200wide x 600deep x 1800mm high Blade, which is designed to be cut with very little waste from standard sheet sizes and extrusion lengths. Customised dimensions can be supplied as a project demands.
- Higher wall modules will usually require a deeper footprint.
- Face Panels can be made from a variety of materials, but are supplied as standard in 16mm E0MDF. Alternative Face panel materials are available as a special order, such as Lightweight 18mm Ply - half the weight of MDF for example. The location of face panels-to-cross rails relies upon pocketed CNC set-outs; as such replacement face panels can be ordered and supplied with split-batons pre-fitted, ready to hang.
 - The Face Panel is intended to be a disposable commodity, replaced as or when required. Patching of smaller holes (art hanging for example) is common without reducing the integrity of the panel. Larger penetrations (such as AV screens or showcases) would usually require a replacement face panel at exhibitions end.
 - Face Panels do not need to be returned to Designcase for re-facing or patching; unlike other products on the market there are no on-going legacy costs associated to Face Panels.
- A suite of wall structures will have identical components and therefore all elements are interchangeable on identical walls.
- Standard Wall Modules can be linked together by removing 1 of the face panels, bolting the inner frames together and re-hanging the face panel. Standard units can be linked end-to-end to make longer runs of straight walls.
- Wall Modules are freestanding and can be mechanically fixed to a series of 'Junctions' to make shaped configurations: L, T, H, Z, etc..
- Assembly and demount of the Wall Modules is a simple process requiring basic hand tools only.
- The standard supply of Face Panels includes a small expressed V-groove between panels; this is a standard arris detail applied to all edges for handling and detail purposes. Sharpe, square edges are vulnerable to damage and very hard to align.
- Our T1 wall system is 100% fabricated in Canberra using Designcase exclusive profiles and extrusion. We offer the facility to supply a range of project specific additions such as mounting Armatures, Object Plinths, etc. or replacement parts (such as face panels), and a high level of customisation as a project demands.

Face Panel options can be tailored to a specific project. Our Standard Module is supplied with 16mm E0MDF, acrylic undercoat painted face panels on both sides. E0MDF is easy to patch (screw/fixing holes) and can be easily re-painted between exhibitions. Alternative face panels and face panel finishes include, but are not limited to:

- **Top-coat roller-applied acrylic paint.** Acrylic paint is usually supplied where re-painting between exhibitions is likely, or re-painting over patched face panels.
- **Graphic wrapped / graphic applied.** For example, when creating a large banner / mural wall structure, or exhibition Entrance Wall.
- **Art Hanging Tracks / Art mounting.** Designcase can supply a number of proprietary hanging track options, or supply a client nominated system. Art Hanging Tracks can be easily installed by client.
- **Pin Board face panels.** T1 Modules can be used as an easy and quick to deploy display wall for Schools Programs / School Tours work for example, or the temporary display of information and brochures.
- **Acoustic face panels,** such as InStyle EchoPanel can also double-up and pin boards. Acoustic panels come in a huge variety of colours, finishes, textures and shapes, and can have printed graphic images applied.
- **Front-of-House / Back-of-House.** T1 walls are often used to create a mobile, easy to deploy barrier wall. Often there is a public and non-public side. In this scenario, we can supply Cloakroom facilities to the non-public side such as pigeon holes and coat/bag hooks.
- **Slat-Wall and Retail.** T1 walls offer an easy to deploy and move retail / merchandise display option, ideal for temporary exhibition merchandise sales, Museum and Gallery shops, pop-up sales, etc. Face panels can be supplied with a proprietary or custom-made slat-wall system, shelving or pigeon holes as required, and supplied with graphic banners advertising the exhibition for example, or conferencing details.

Linking Sections / Corner Junctions and In-fill Blades. Linking T1 walls end-to-end is a simple and easy process; building long straight runs of display wall. The use of simple in-fill sections, 90-degree corner sections, L or X shape linking sections allows more complex foot-print configurations to be made, such as T, L and U-shape spaces and 'rooms'. We also offer a non-standard linking section service which can be made to any angle, or curved and part-curved sections.

Castors and Adjustable Feet. Our Standard T1 Wall Module is supplied with 4, 360degree rotation castors. The Standard module can also be supplied with 2 rotating and 2 fix-direction castors; this combination will further stabilise a series of T1 Modules when linked together in a shaped configuration. Locking castors can also be supplied, however it is important to note that it is difficult to engage the locking mechanism on all castors when walls are linked together. Adjustable feet help stabilise the wall structure, and are used to lift the castor off of the floor. When building runs of walls, adjustable feet help compensate for uneven floors. Simply retract the adjustable foot and the castors re-engage with the floor. Use the adjustable feet if the wall structure is not being relocated on a regular basis.

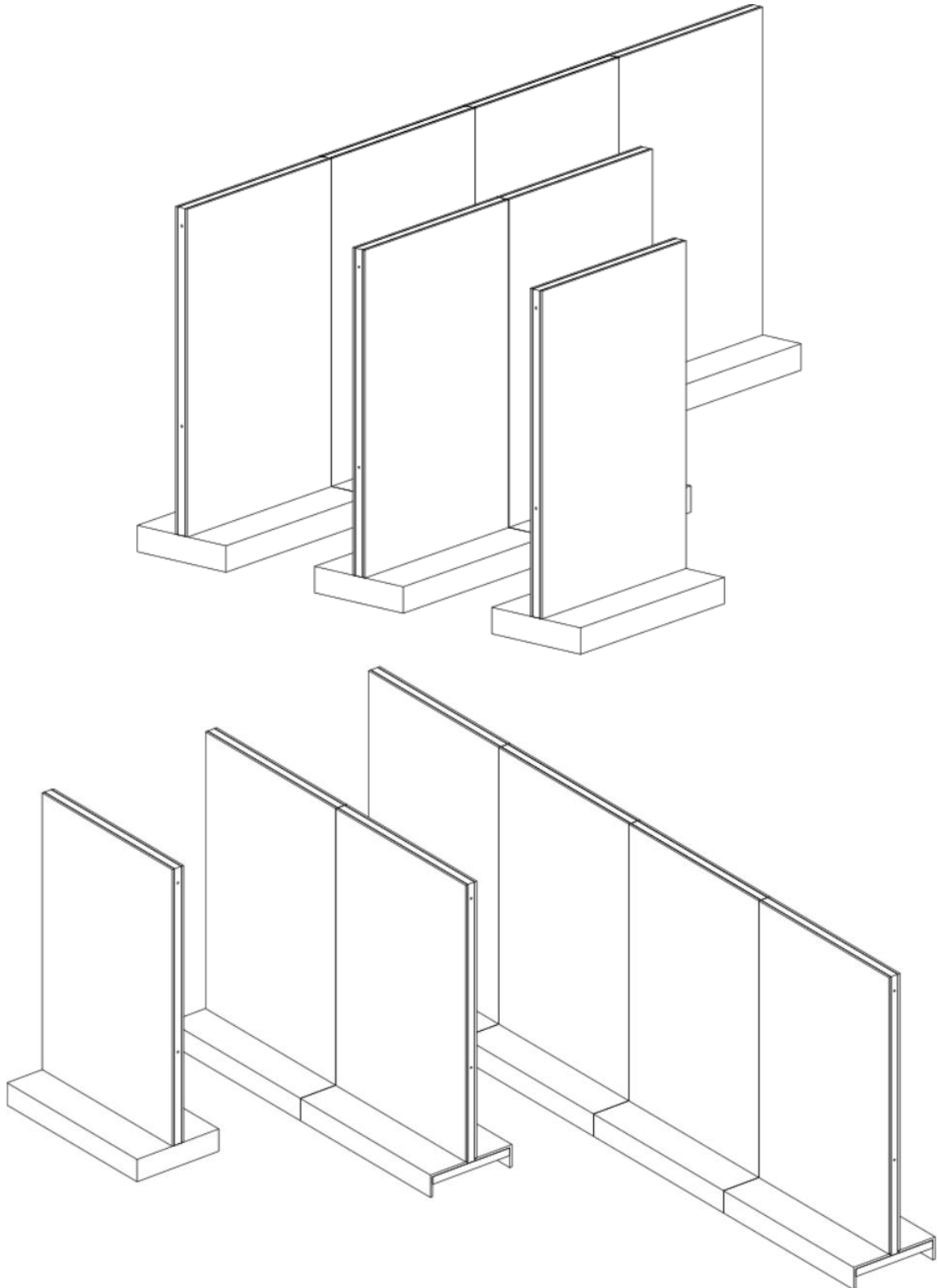

Standard, straight Wall Modules can be linked end-to-End, by simply bolting the inner frames together, and replacing the face panels. Depending on castor selection, linked Modules can be moved and positioned as required. End Caps are supplied to cover the internal framing if/as required.

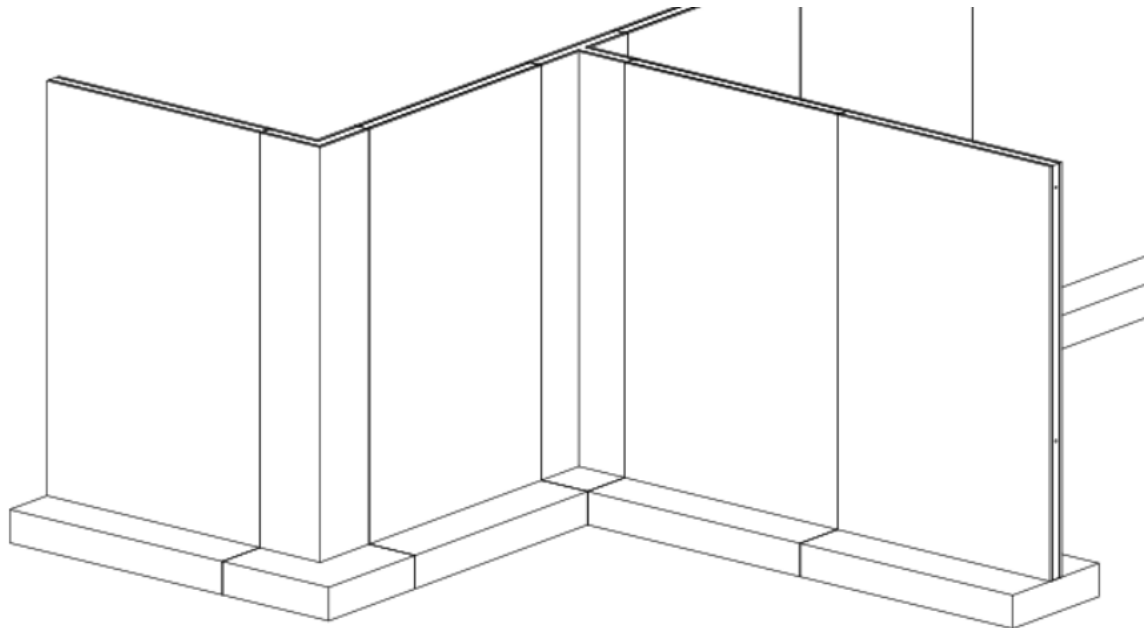
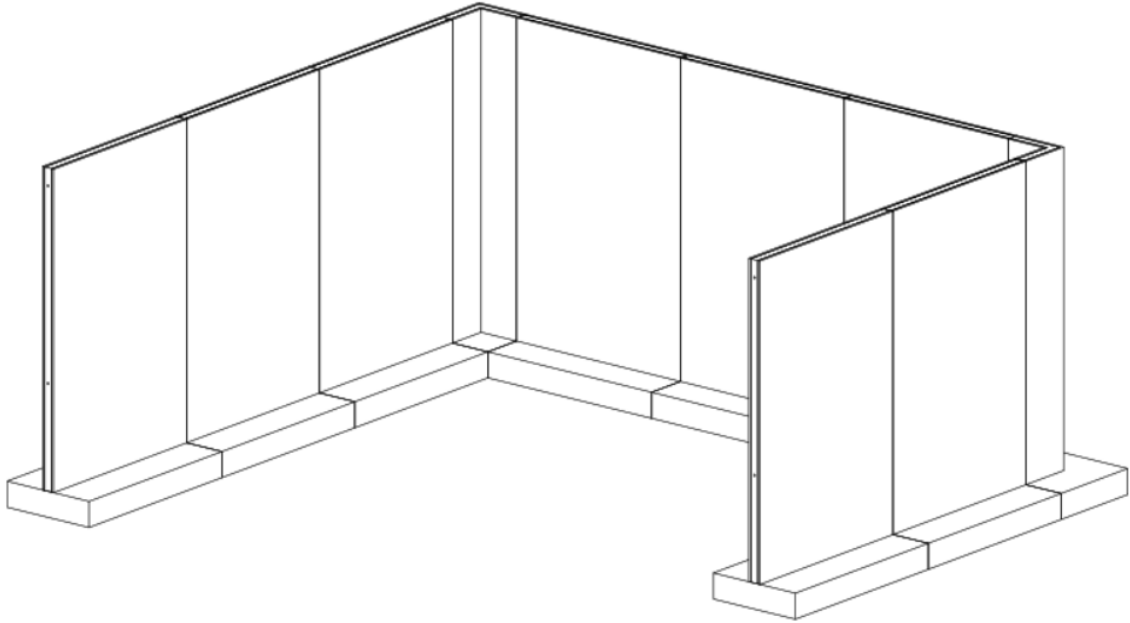

Standard, straight Wall Modules can also be linked together using a number of different Junction options. Straight Modules bolt to the corresponding Junction. The Junctions are supplied with castors and structural bottom frames, and are made to order, matching the face panel section of the Standard / Straight Module.

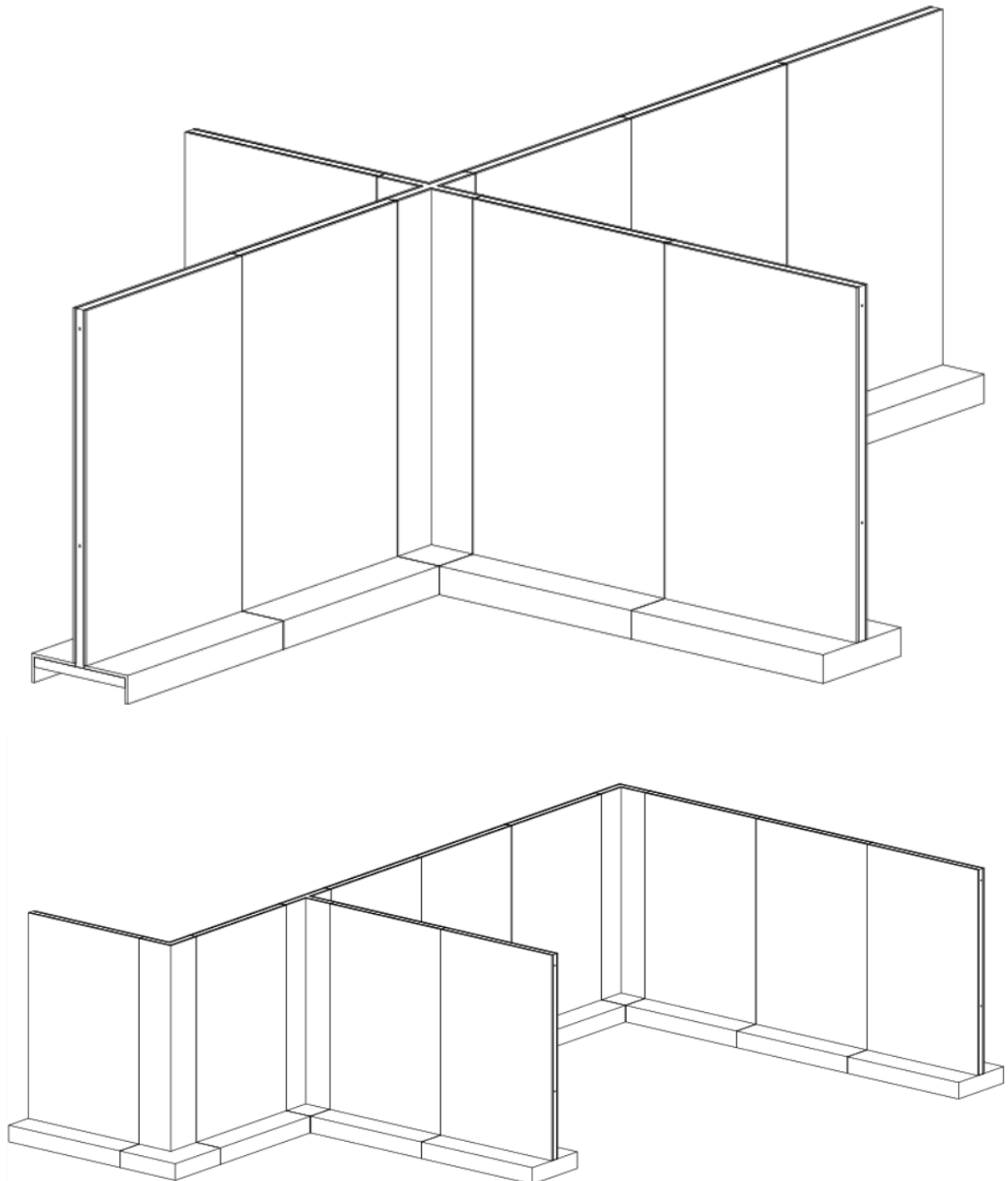

More complex configurations can be achieved by using Junctions. 2-way (L-shape), 3-way (T-shape) and 4-way (X-shape) Junctions allow Standard/Straight Modules to be linked at 90degree intersections to create more dynamic and versatile configurations. The top illustration shows wall modules with and without End Capping.

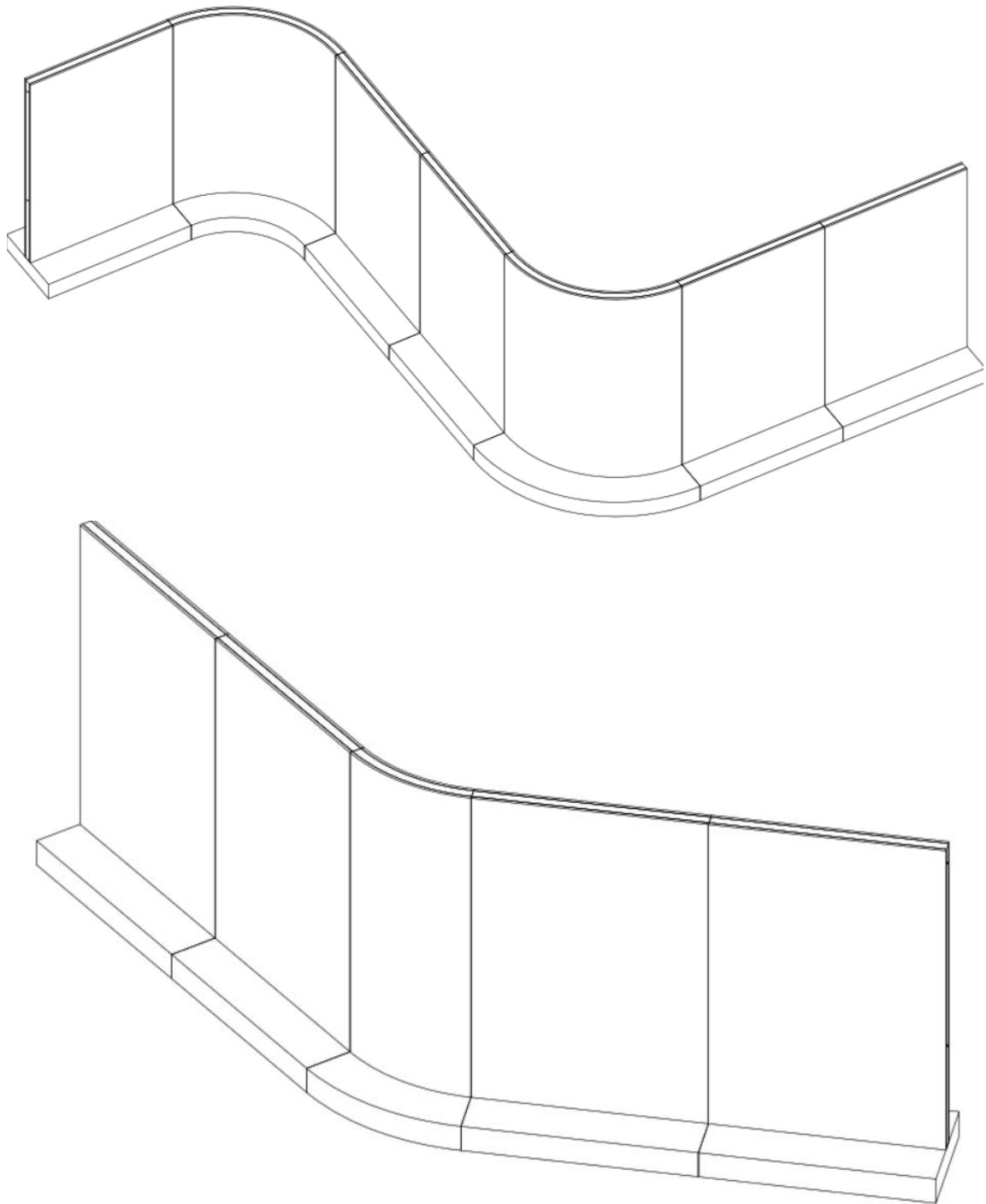

Custom-made and curved Junctions or linking modules add another dynamic to the proprietary T1 wall system Module. Combining proprietary and custom-made elements allows clients to generate a unique kit-of-parts. Being made locally in our Canberra factory, providing custom-made / customer-specified modifications is an easy process and uniquely positions the Designcase T1 wall system in the market. We would welcome the opportunity to discuss both the Proprietary System and our custom-made capabilities.